

Grid:  
 ≥ 2,54 mm  
 ≥ 100 Mil

# Contact Terminals

for Interfaces and Transfer Fields

e-type® Probes  
 ICT / FCT  
 Bead Probes  
 Fine Pitch  
 Metric Stand.  
 Solderable  
 Short-stroke  
 Flying Probes  
 DKS  
 SKS  
 PKS / PSK  
 RF / Dipole Test Probes  
 HSS  
 Fixture customizing  
 Tools  
 Cable Test Probes

## Contact Terminals with Collar Height: 3 mm (.118)

### KT-254 W-E03 (wire-wrap)

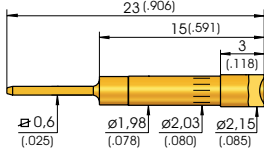

### KT-254 W3 E03 (wire-wrap)

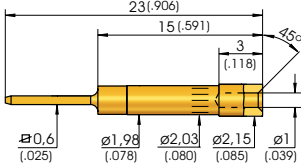

### KT-254 L-E03 (Solder)

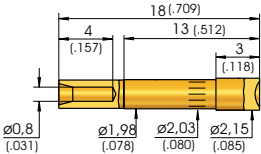

### KT-254 L3 E03 (Solder)

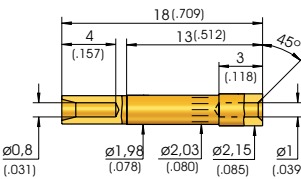

### KT-120 L3 E02 - 30 (Solder) High-current Contact Terminal

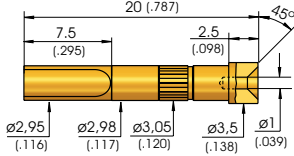

### KT-150 L3 E03 - M3 High-current Contact Terminal

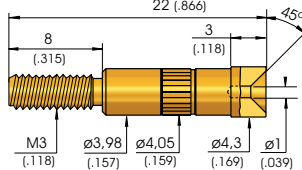

## Contact Terminals with Collar Height: 2 mm (.079)

### KT-254 W-E02 (wire-wrap)

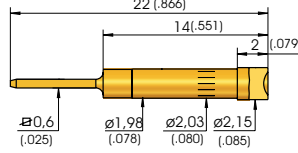

### KT-254 W3 E02 (wire-wrap)

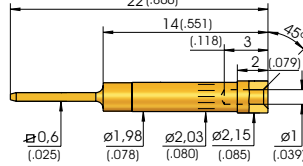

### KT-254 L-E02 (Solder)

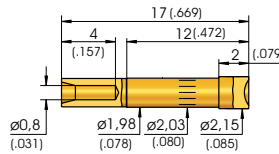

### KT-254 L3 E02 (Solder)

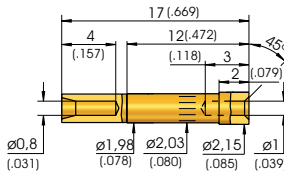

### KT-254 L3 E02 - 30 (Solder Connection)

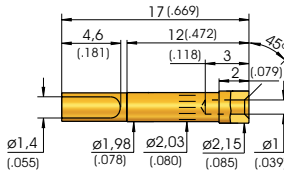

### KT-254 W-PL (wire-wrap)

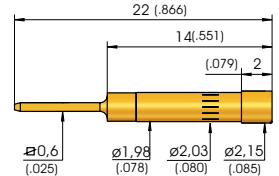

## Other Contact Terminals:

### KT-254 W3 E12 (wire-wrap) For assembly in INGUN-ZSK Transfer Field (ZSK = Top-side Contacting Unit)

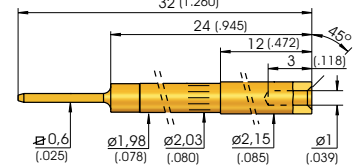

### KT-158 02 (Order No. 9408) Contacting Terminal for GenRad Interface

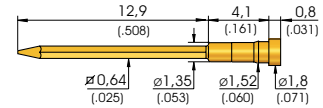

### KT-158 (Order No. 3650) Contacting Terminal for Zehntel Interface

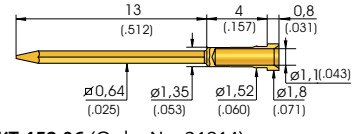

### KT-158 06 (Order No. 21814)

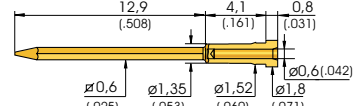

### KT-586 102 400 R Contacting Terminals for general usage

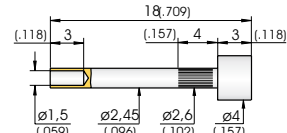

### KT-279 102 300 (to solder in)

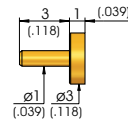

### KT-112 143 215 E02 (Replaceable) Will be used with KS-112, see Page 50)

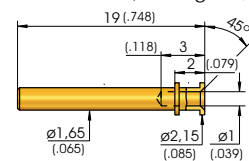

## Mounting Hole Size \*

### for KT-254:

in CEM1 ø 1,98 - 2,00 mm (.0780-.0787)

in FR4 ø 1,98 - 1,99 mm (.0780-.0783)

### for KT-158:

in CEM1 and FR4 ø 1,40 mm (.0551)

### for KT-586:

in CEM1 and FR4 ø 2,55 - 2,57 mm  
 (.1004-.1012)

### for KT-120:

in CEM1 and FR4 ø 3,00 - 3,02 mm  
 (.1181 - .1189)

### for KT-150:

in CEM1 and FR4 ø 4,00 - 4,02 mm  
 (.1575 - .1583)

### \* Services:

Customized Contact Blocks drilled according to customer demands (and matching certain INGUN Receptacles) are available from INGUN.

## Electrical Data

R<sub>i</sub> typical: < 5 mΩ

## Materials

Contact Terminals: Brass, gold-plated  
 KT-586: Brass, rhodium-plated

## Collar Height and Install. Height for KT-254

The Installation Height of the Contact Terminals is determined by the collar Height.